

LME_L LONG LINEAR BUSHING

● Drawing

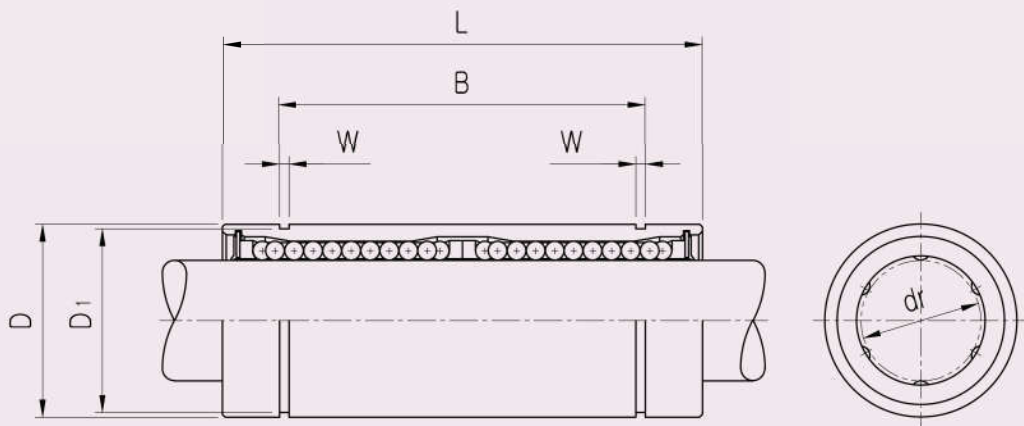

● Part Number Notation

LME 20 L UU - A N S



- European Standard Samick Linear Bushing
- Nominal Shaft Diameter
- Linear Bushing Long Type (for high load)
- Seal

| | |
|-------|----------------|
| Blank | No Seal |
| UU | Both Side Seal |
| U | One Side Seal |

- Retainer (material)

| | |
|-------|--|
| Blank | Resin Retainer(Standard) |
| A | Steel Retainer(High temperature) ^{★1} |

- Outer-sleeves (by corrosion resistance)

| | |
|-------|----------------------------|
| Blank | Standard(SUJ2) |
| N | Electroless nickel plating |
| R | Raydent treatment |

- Ball type (material)

| | |
|-------|--|
| Blank | High carbon bearing steel ball(Standard) |
| S | Stainless steel ball |

★1 Steel retainer applicable from LME8L to LME25L only

LME_L LONG LINEAR BUSHING

| PART NUMBER | | WORKING BORE DIAMETER | | D | | L | | B | | W | D ₁ | BASIC LOAD RATING(N) | | NO. OF BALL ROW | WEIGHT (gf) ^{*2} |
|-------------|----------|-----------------------|------------------|----|---------------|-----|---------------|-------|---------------|------|----------------|---------------------------|-------------|-----------------|---------------------------|
| Resin | Steel | dr. (mm) | CLEARNCE (mm) | mm | CLEARNCE (mm) | mm | CLEARNCE (mm) | mm | CLEARNCE (mm) | | | DYNAMIC (C) ^{*1} | STATIC (Co) | | |
| LME8LUU | LME8L-A | 8 | +0.009 -0.001 | 16 | 0 -0.009 | 45 | 0 -0.3 | 33 | 0 -0.3 | 1.1 | 15.2 | 430 | 780 | 4 | 31 |
| LME12LUU | LME12L-A | 12 | | 22 | 0 -0.011 | 57 | | 45.8 | | 1.3 | 21 | 650 | 1200 | 4 | 80 |
| LME16LUU | LME16L-A | 16 | +0.011 -0.001 | 26 | 0 -0.013 | 70 | 0 -0.4 | 49.8 | 0 -0.4 | 1.3 | 24.9 | 1230 | 2350 | 5 | 145 |
| LME20LUU | LME20L-A | 20 | | 32 | | 80 | | 61 | | 1.6 | 30.3 | 1400 | 2750 | 5 | 180 |
| LME25LUU | LME25L-A | 25 | +0.013 -0.002 | 40 | 0 -0.015 | 112 | 0 -0.4 | 82 | 0 -0.4 | 1.85 | 38 | 1560 | 3140 | 6 | 440 |
| LME30LUU | | 30 | | 47 | | 123 | | 104.2 | | 1.85 | 44.5 | 2490 | 5490 | 6 | 580 |
| LME40LUU | | 40 | +0.016 -0.004 | 62 | 0 -0.020 | 154 | 0 -0.4 | 121.2 | 0 -0.4 | 2.15 | 59 | 3430 | 8040 | 6 | 1170 |
| LME50LUU | | 50 | | 75 | | 192 | | 155.2 | | 2.65 | 72 | 6080 | 15900 | 6 | 3100 |
| LME60LUU | | 60 | | 90 | | 211 | | 170 | | 3.15 | 86.5 | 7650 | 20000 | 6 | 3500 |

- ★1 Dynamic load rating is based on the nominal life of 50km
In case of 100km, C on the table need to be divided by 1.26
Ex) 50km basic dynamic load rating(C) of LME12L = 650N
100km basic dynamic load rating(C₁₀₀) of LME12L = 650/1.26 = 515.87N
- ★2 Based on the weight of resin retainer
- ★3 Main unit : mm
- ★4 1N ≒ 0.102kgf